

GALAXY
1:50

Existing Ride (pictured)
relocated onto New base

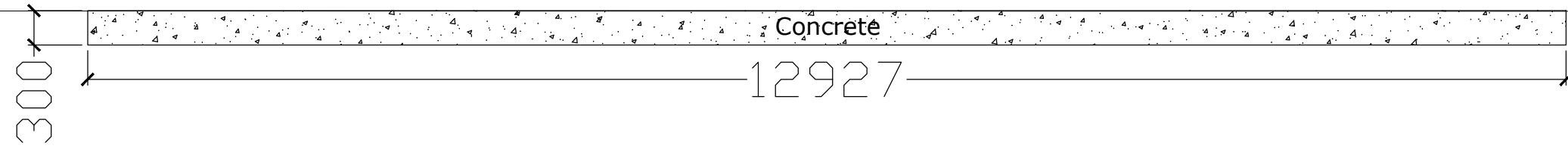

TRAMPOLINE
RIDE

new ride in new position

1:50

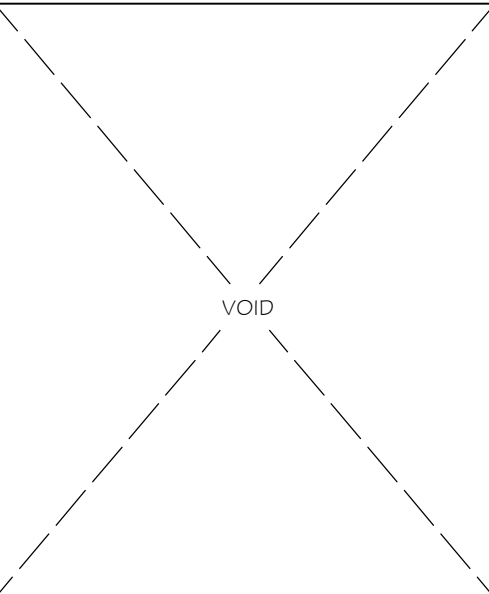
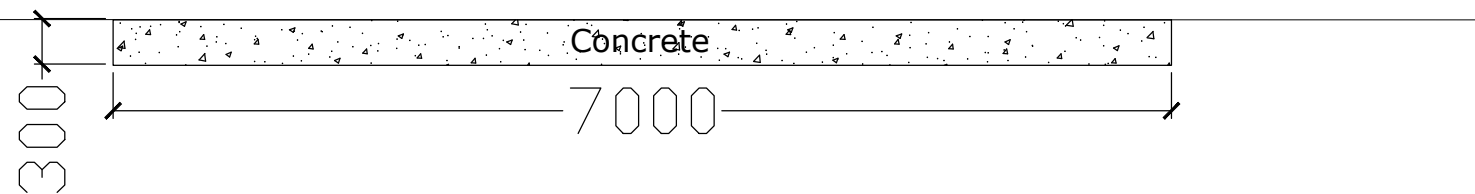

- ☐ AS BUILT DRAWING
- ☐ LICENSING
- ☐ SURVEY
- ☐ CONSTRUCTION ISSUE
- ☐ TENDER ISSUE
- ☐ BUILDING REGULATIONS
- ☒ LPA SUBMISSION
- ☐ LPA PRE-APP DRAWING
- ☐ FEASIBILITY DRAWING
- ☐ CLIENT APPROVAL
- ☐ REVISION

Rev	Date	Description
01	03/22	LPA supporting information

SAFETY, HEALTH, & ENVIRONMENT INFORMATION
Based on the use of experienced and competent contractors working to an approved method statement unusual residual hazards / risks are identified as per the following symbols:

- We use this symbol to give warning of significant hazards or information which is unusual
- We use this symbol to encourage a particular action
- We use this symbol when we want you to avoid something or refrain from a particular action
- We use this symbol when we want to convey some relevant CDM information

The design team have highlighted unusual and significant risks only that may not be obvious to a competent contractor. They are to assist with risk reduction only and are not necessarily comprehensive.

Customer BRAND:

Butlin's

Project:
NEW FAIRGROUND AND
ARCADE DEVELOPMENT

Client:
BUTLINS RESORT
ROMAN BANK
SKEGNESS
PE25 1NJ



Drawn: DK Approved: MARCH 22
Scale: 1:50 & 1:100 @ A1 PRINT SIZE

Sheet Description:
GALAXY RIDE AND
TRAMPOLINE BASES

Sheet Number: IPL18_131.62_120 Issue: 01-LPA