

FAIRGROUND RIDE & LIGHTING COLUMN BASE SECTIONS  
SCALE 1:100 & 1:50

ROCKING TUG RIDE  
Scale 1:50

Existing Ride (pictured) relocated onto New base

Red Lighting Column Positions - 29Nr.

Supply and install 29 Nr. Galvanised Steel lamp posts 5.5m long x 120mm diameter Seamless Galvanised steel tube with 1.0m inserted into the ground bedded and Surrounded with concrete pre-painted with bitumen, and 4.5m above ground. Manufacture as Design Provided to afford fixing of Festoon Lighting with Steel Catenary wire (See Setting out Drawing)

FESTOON LIGHTING COLUMNS  
Scale 1:50

CAROUSEL GALLOPERS RIDE  
Scale 1:50

Existing Ride (Photographed) Relocated onto New base



ELECTRICAL CABIN  
Scale 1:50

Green GRP control structure on new base

ROCKING TUG RIDE  
Scale 1:50

Existing Ride (pictured) relocated onto New base

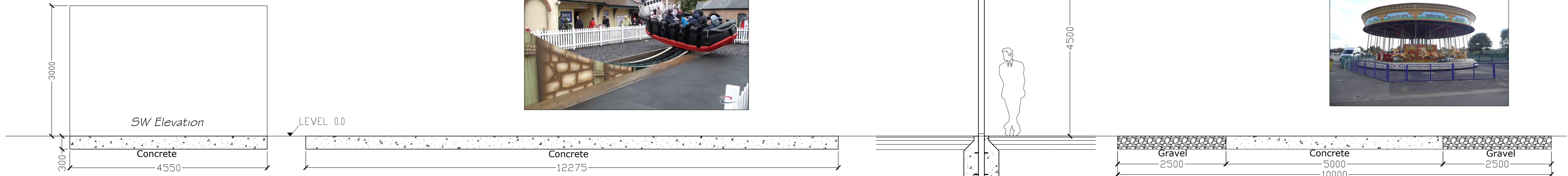

ELECTRICAL CABIN ELEVATIONS  
Scale 1:100

Green GRP control structure on new base

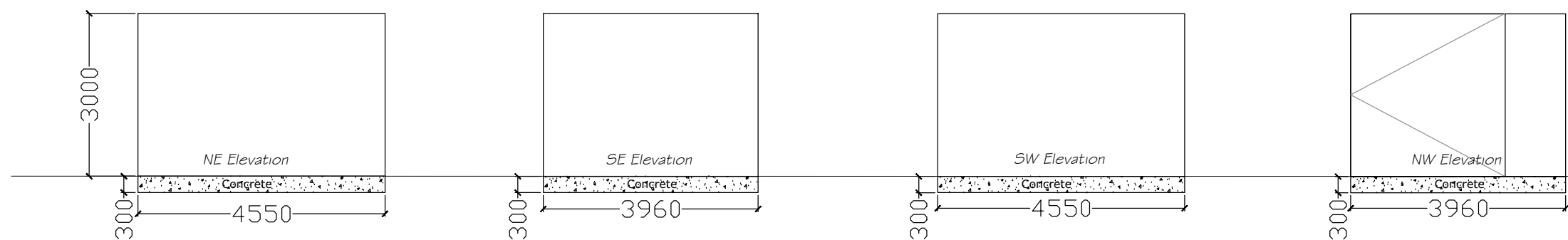

Attention:  
The dimensions of the room are approximate  
and for reference only

ELECTRICAL MECHANICAL ROOM  
(SHOWN FOR REFERENCE ONLY)  
TEMPERATURE REQUIREMENTS  
MIN 5°C - MAX 40°C  
MIN MAKE-UP AIR: 110 m³/h (100 cfm)

ELECTRICAL CABIN SECTION  
Scale 1:100

Green GRP control structure on new base

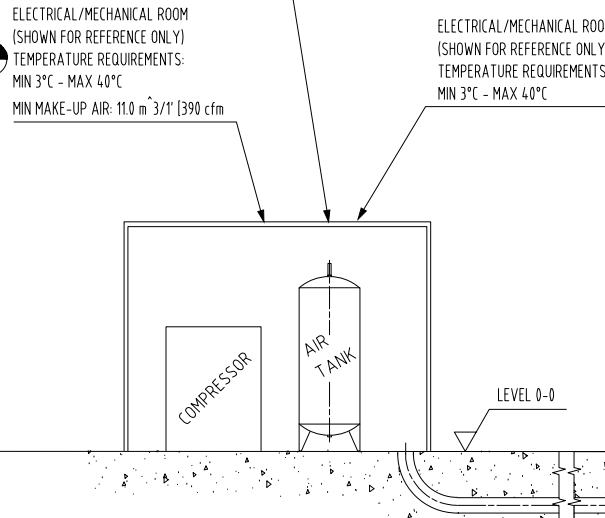

ROOF PLAN VIEW  
Scale 1:100

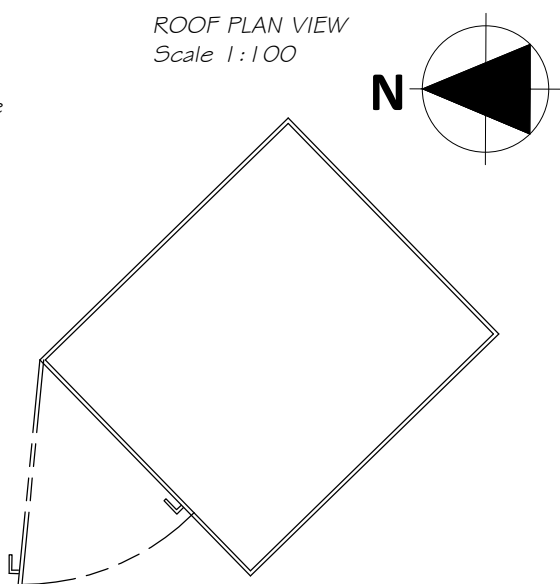

Covered Seating Area

Supply and install 10Nr. Galvanised Steel Lamp Posts 5.5m long x 120mm diameter, Seamless Galvanised steel tube with 1.0m inserted into the ground bedded and surrounded with concrete pre-painted with bitumen, and 4.5m above ground. Manufacture as Design provided to afford fixing of steel catenary wire (See setting out drawing)

1 : 100

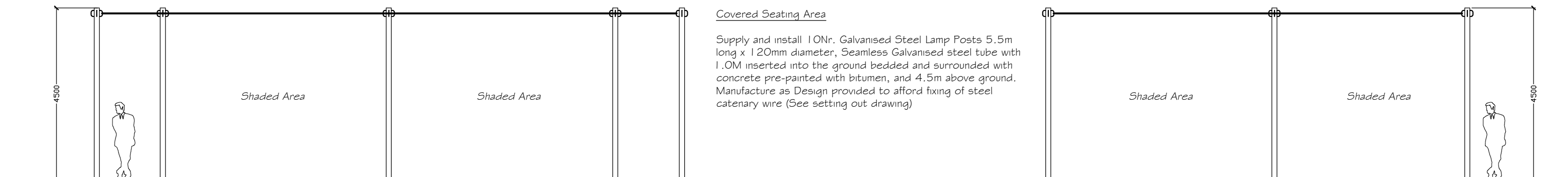

CANOPY NORTH EAST ELEVATION  
Scale 1:100

CANOPY SOUTH EAST ELEVATION  
Scale 1:100

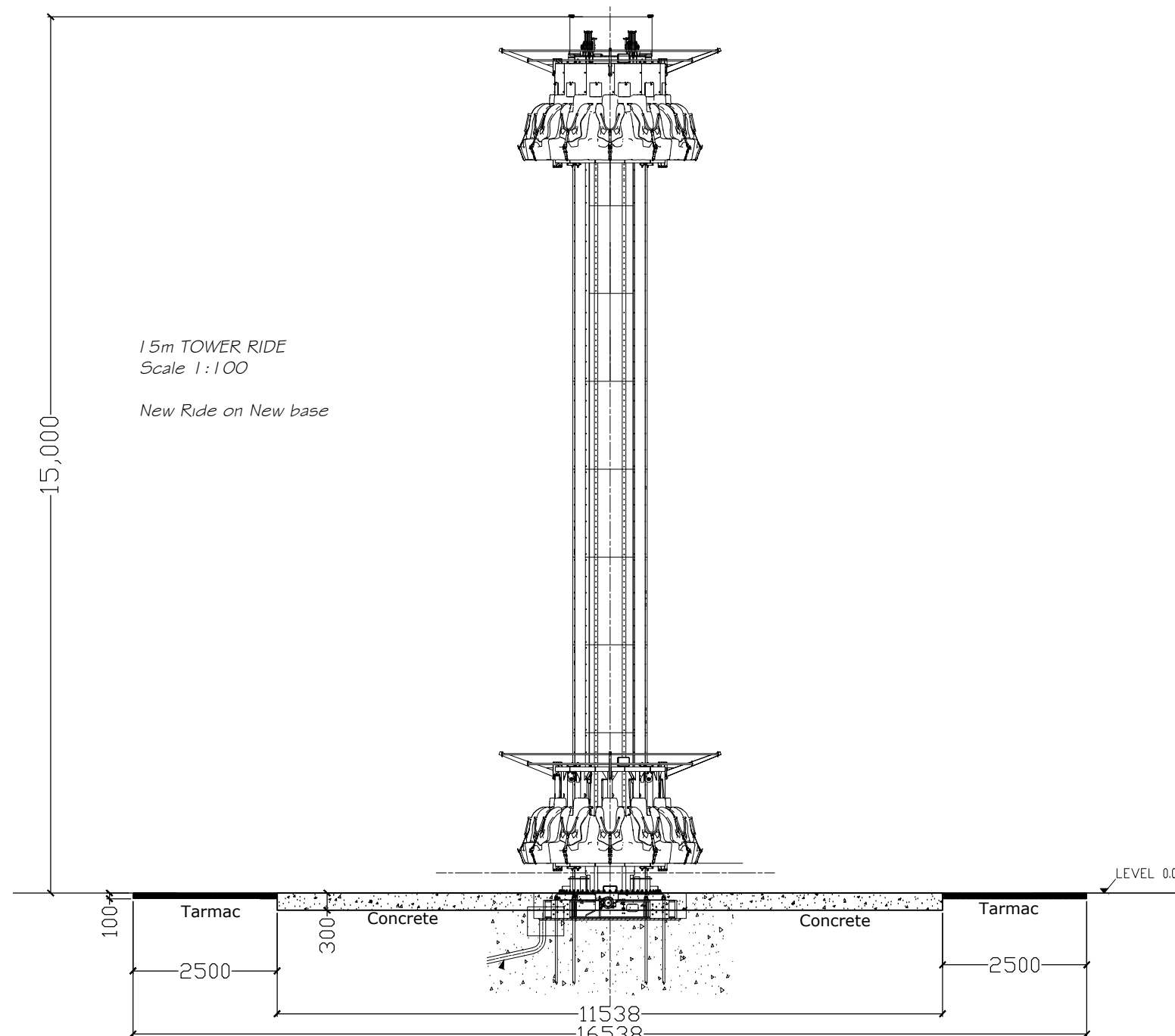

CHRONOZ RIDE  
Scale 1:100

New Ride on New base

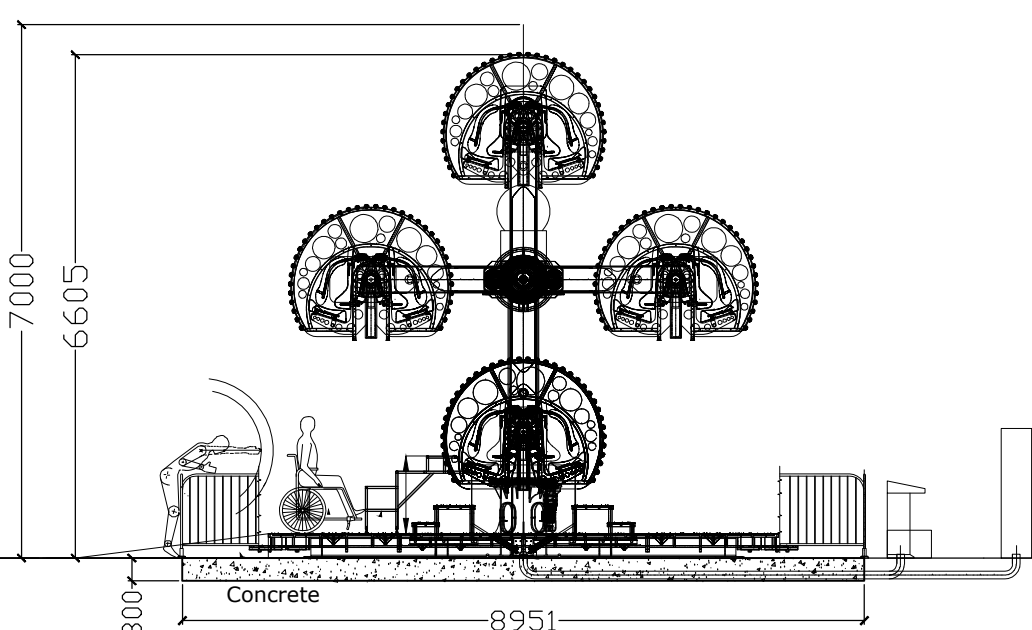

Red Lighting Column Positions - 29Nr.

Supply and install 29 Nr. Galvanised Steel lamp posts 5.5m long x 120mm diameter Seamless Galvanised steel tube with 1.0m inserted into the ground bedded and Surrounded with concrete pre-painted with bitumen, and 4.5m above ground. Manufacture as Design Provided to afford fixing of Festoon Lighting with Steel Catenary wire (See Setting out Drawing)

Scale 1:100

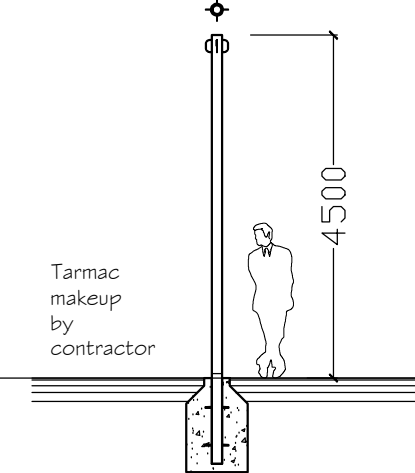

SWING RIDE  
Scale 1:100

New Ride on New base

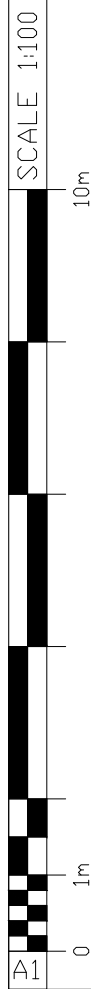
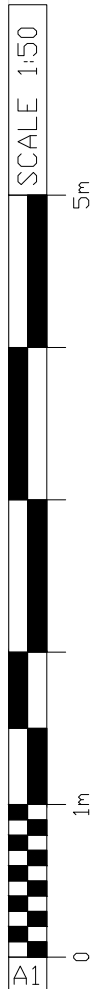
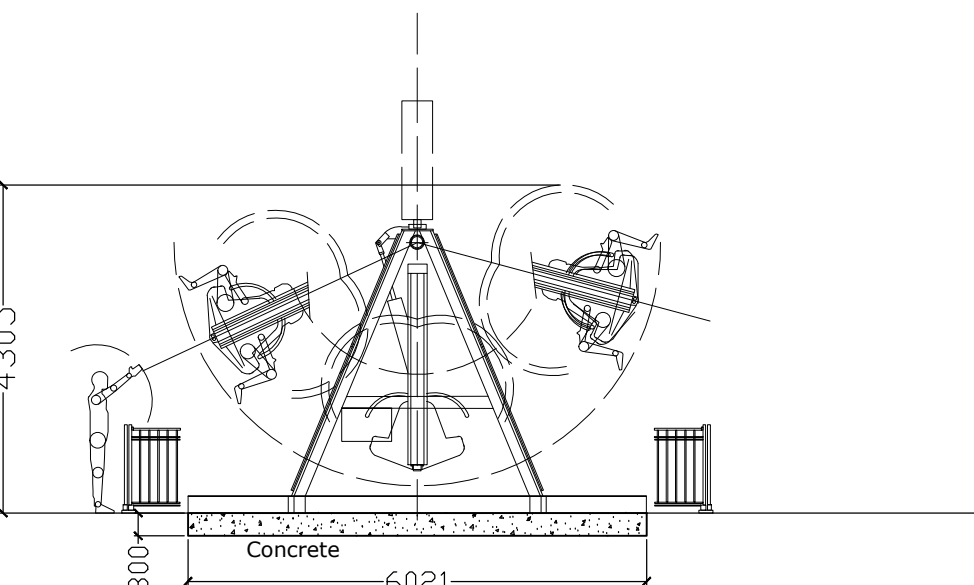

VOID

- ☐ AS BUILT DRAWING
- ☐ LICENSING
- ☐ SURVEY
- ☐ CONSTRUCTION ISSUE
- ☐ TENDER ISSUE
- ☐ BUILDING REGULATIONS
- ☒ LPA SUBMISSION
- ☐ LPA PRE-APP DRAWING
- ☐ FEASIBILITY DRAWING
- ☐ CLIENT APPROVAL
- ☐ REVISION

Rev	Date	Description
01	01/22	PH only issued for QS
02	02/22	Chronoz to replace Midi
03	05/22	Tower reduced to 15m

**SAFETY, HEALTH, & ENVIRONMENT INFORMATION**  
Based on the use of experienced and competent contractors working to an approved method statement unusual residual hazards / risks are identified as per the following symbols:

- We use this symbol to give warning of significant hazards or information which is unusual
- We use this symbol to encourage a particular action
- We use this symbol when we want you to avoid something or refrain from a particular action
- We use this symbol when we want to convey some relevant CDM information

The design team have highlighted unusual and significant risks only that may not be obvious to a competent contractor. They are to assist with risk reduction only and are not necessarily comprehensive.

Customer BRAND:

**Butlin's**

Project:  
NEW FAIRGROUND AND ARCADE DEVELOPMENT

Client:  
BUTLINS RESORT  
ROMAN BANK  
SKEGNESS  
PE25 1NJ



Drawn: DK Approved: MARCH 22  
Scale: 1:50 & 1:100 @ A1 PRINT SIZE

Sheet Description:  
SECTIONS FOR BASES OF FAIRGROUND RIDES

Sheet Number:  
IPL18\_131.62\_118  
Issue:  
03-LPA