

Existing Site Plan @ 1:500

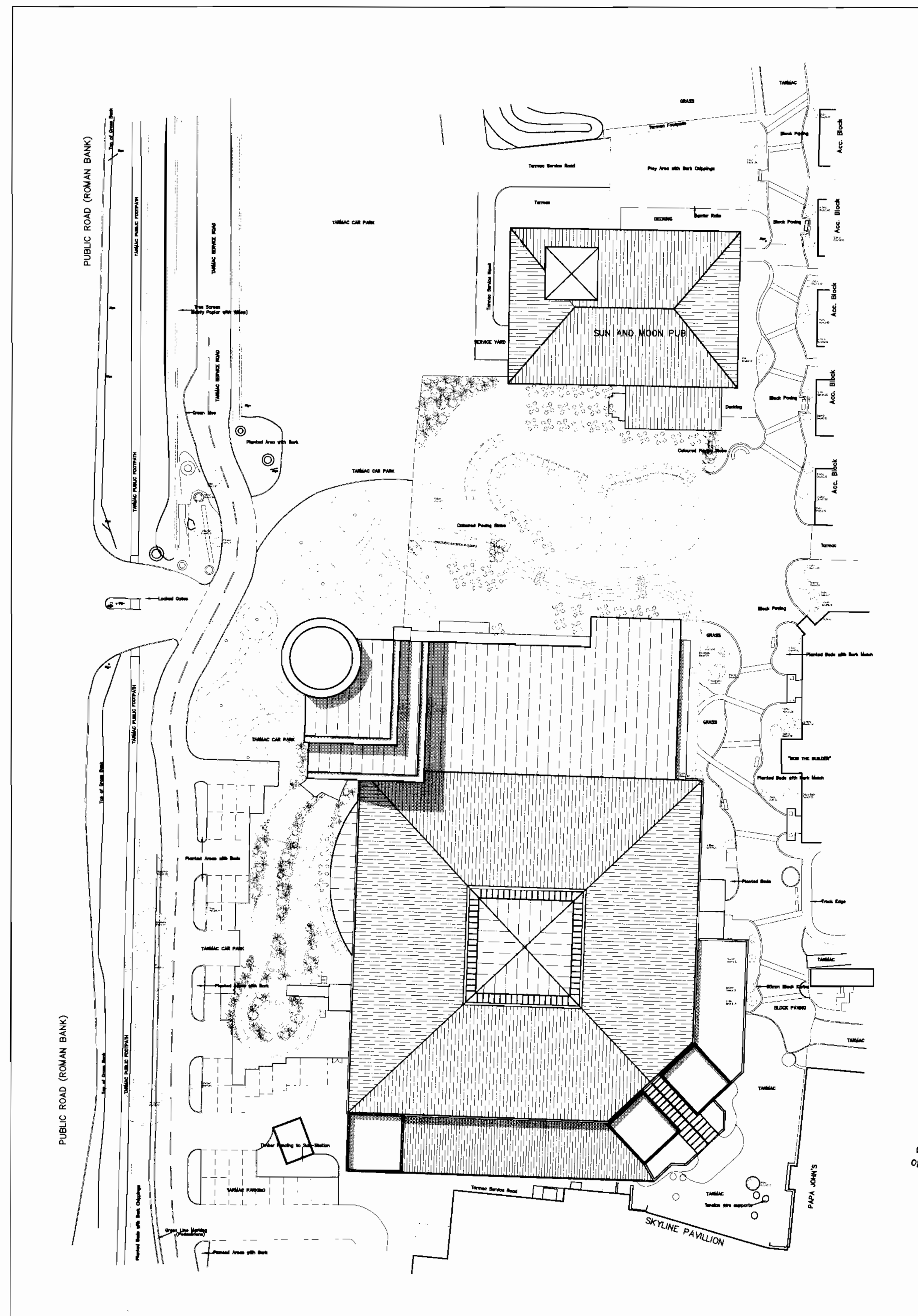

Proposed Site Plan @ 1:500

S/090/1336/11

This copy has been made
 from the original drawing
 and is not to be used for
 any other purpose without
 the written permission of
 the author.

29 JUL 2011

N
 PLANNING

HolderMathiasarchitects

Splash Pool Redevelopment
 Butlins, Skegness
 Bourne Leisure Ltd

Job No: 3720
 Draw No: AL(90)03
 Rev:

Title: Existing & Proposed Site Plans
 Date: 20/07/11
 Drawn: RC
 Check: JTW
 Status: Planning
 Scale: 1:500 @ A1

Call: 020 2048 8881
 London: 020 7287 0735
 www.holdermathias.com