

	Client Approval
	A - Approved
X	B - Approved with Comments
	C - Do Not Use

Client: Butlins Skegness Resort
Roman Bank



Drawn: DS Date: Aug '15

Topographical Survey		
Sheet Number: S2 171 002	No: 2	Rev:

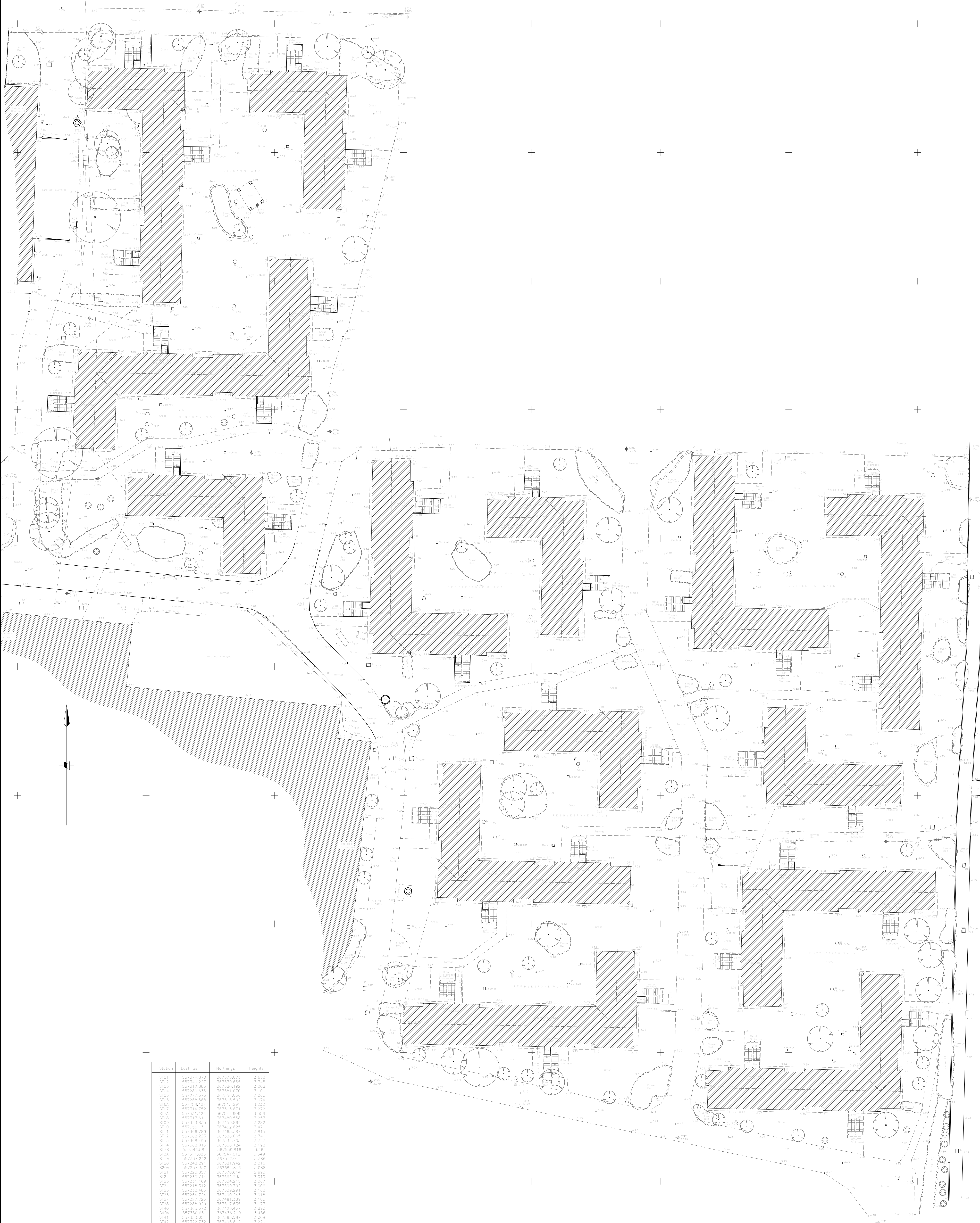

Station	Estimates	Northings	Height
507	55737.4870	576579.013	3.620
508	55749.227	576817.057	3.348
509	55750.715	576817.057	3.348
510	55750.635	576817.057	3.348
511	55750.635	576817.057	3.348
512	55750.635	576817.057	3.348
513	55768.688	576145.592	3.074
514	55768.688	576145.592	3.074
515	55768.688	576145.592	3.074
516	55768.688	576145.592	3.074
517	55768.688	576145.592	3.074
518	55768.688	576145.592	3.074
519	55768.688	576145.592	3.074
520	55768.688	576145.592	3.074
521	55768.688	576145.592	3.074
522	55768.688	576145.592	3.074
523	55768.688	576145.592	3.074
524	55768.688	576145.592	3.074
525	55768.688	576145.592	3.074
526	55768.688	576145.592	3.074
527	55768.688	576145.592	3.074
528	55768.688	576145.592	3.074
529	55768.688	576145.592	3.074
530	55768.688	576145.592	3.074
531	55768.688	576145.592	3.074
532	55768.688	576145.592	3.074
533	55768.688	576145.592	3.074
534	55768.688	576145.592	3.074
535	55768.688	576145.592	3.074
536	55768.688	576145.592	3.074
537	55768.688	576145.592	3.074
538	55768.688	576145.592	3.074
539	55768.688	576145.592	3.074
540	55768.688	576145.592	3.074
541	55768.688	576145.592	3.074
542	55768.688	576145.592	3.074
543	55768.688	576145.592	3.074
544	55768.688	576145.592	3.074
545	55768.688	576145.592	3.074
546	55768.688	576145.592	3.074
547	55768.688	576145.592	3.074
548	55768.688	576145.592	3.074
549	55768.688	576145.592	3.074
550	55768.688	576145.592	3.074
551	55768.688	576145.592	3.074
552	55768.688	576145.592	3.074
553	55768.688	576145.592	3.074
554	55768.688	576145.592	3.074
555	55768.688	576145.592	3.074
556	55768.688	576145.592	3.074
557	55768.688	576145.592	3.074
558	55768.688	576145.592	3.074
559	55768.688	576145.592	3.074
560	55768.688	576145.592	3.074
561	55768.688	576145.592	3.074
562	55768.688	576145.592	3.074
563	55768.688	576145.592	3.074
564	55768.688	576145.592	3.074
565	55768.688	576145.592	3.074
566	55768.688	576145.592	3.074
567	55768.688	576145.592	3.074
568	55768.688	576145.592	3.074
569	55768.688	576145.592	3.074
570	55768.688	576145.592	3.074
571	55768.688	576145.592	3.074
572	55768.688	576145.592	3.074
573	55768.688	576145.592	3.074
574	55768.688	576145.592	3.074
575	55768.688	576145.592	3.074
576	55768.688	576145.592	3.074
577	55768.688	576145.592	3.074
578	55768.688	576145.592	3.074
579	55768.688	576145.592	3.074
580	55768.688	576145.592	3.074
581	55768.688	576145.592	3.074
582	55768.688	576145.592	3.074
583	55768.		